

*Light & Ergonomic Pipette*  
**NICHIRYO** *Le*

Digital micro pipette for liquid handling

# User's Manual

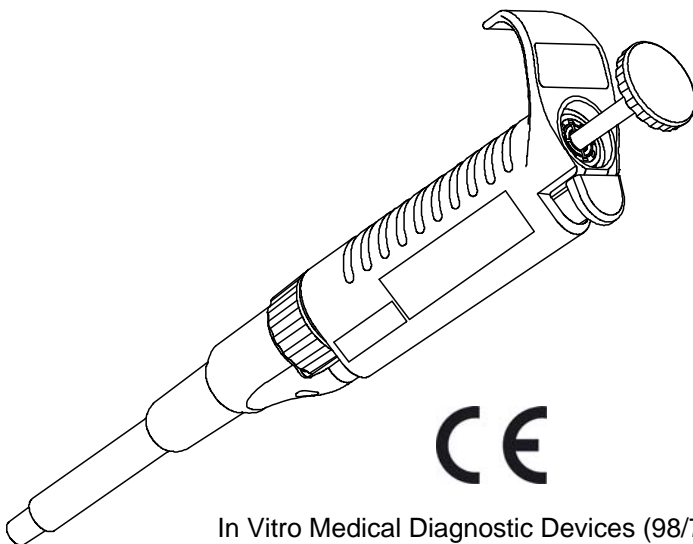

**CE**

In Vitro Medical Diagnostic Devices (98/79/EC)  
Annex III self-declared  
ISO 8655 STANDARD

CERTIFIED ISO9001

- Thank you very much for purchasing NICHIRYO Le.
- Please read this manual carefully before using.

# *Light & Ergonomic Pipette*

# **NICHIRYO** *Le*

- Thank you for purchasing the NICHIRYO Le.
- Before proceeding to work with the NICHIRYO Le, please carefully read this manual for proper use of it.

## **I. Introduction**

This operator's manual explains the operation of the Nichiryo Digital Micro Pipette 'NICHIRYO Le'. Please read carefully to ensure safe and correct operation of the instrument. Please pay special attention to passages marked in bold lettering. Be sure to read cautions that need strict observance and underlined sections before using the instrument.

## **II. Features**

- As volume amount setting is done digitally, easy volume setting is possible with a simple press of the push button.
- Through adoption of an easy to grasp design and a lightweight construction, (in comparison with our Nichipet EX model) we have realized a product design that allows long hours of use without operator fatigue.
- The structure of the unit has been designed to reduce the effects of hand temperature on performance accuracy.
- Our lineup of 5 different models allows a wide range of sampling, between 1.0ul – 1000ul.

## **III. Standard Accessories**

- Tips: x 3
- Grease: x 1
- User's Manual

When unpacking package, check to make sure that the above-mentioned items are included.

## **IV. Safety Precautions**

- Please be sure to carefully read the sections titled "Safety Precautions" and "⚠ Cautions:" before using the instrument.
- The contents of "CAUTIONS" are matters that require the user's attention, not only for using the Nichiryo Le properly but for preventing the user from accidents and physical damage.
- After reading this manual, please keep it in a convenient place for easy referral at any time.

Please read the following prior to use for your safety and correct usage of the instrument.

# **CAUTIONS**

Be sure to observe the following instructions for using the NICHIRYO Le properly and safely

1. Do not use this instrument for any purpose except pipetting liquid.
2. Do not modify this instrument as modification may cause an accident.
3. Do not use this instrument for pipetting any liquid to be injected into the human body.
4. Do not eject the tip towards anybody.
5. Do not discharge any sample liquid while pointing the instrument at anybody. Some liquids are dangerous and may cause bodily harm.
6. Do not eject the tip while liquid is still inside.
7. Handle the tip with care, as the point is sharp and dangerous.
8. Firmly attach the tip to the nozzle. If not attached securely it may fall off causing the sample liquid to scatter.
9. When handling liquid harmful to the human body, be careful not to directly touch the tip during or after use.
10. If the instrument is soiled with liquid harmful to the human body, immediately take proper measures to clean it safely before proceeding with work.
11. Do not use this instrument for stirring liquid or for any other such action. Additionally, do not use the instrument in any manner that will cause the tip to loosen, fall off, or the instrument itself to be soiled with scattered liquid.
12. Do not use this instrument for any purpose except pipetting liquid.

## Please review before using

Users are required to strictly observe the following points in order for the instrument to retain its precision and original performance for a long time.

1. Do not expose this instrument directly to the sun when working with it, or for 2 hours before starting work, otherwise the instrument may fail in precise pipetting. Avoid working with this instrument in a humid and hot place.
2. Just before starting work with this instrument, avoid touching the tip and nozzle cylinder as far as circumstances permit. If the nozzle cylinder is warmed by your hand, it is hard to maintain accuracy.
3. For pipetting, follow the forward method (explained in this manual). If it is performed in a different way, it may result in inaccurate pipetting.
4. Operate the push button slowly. If quickly released, sample liquid will be sucked into the main body, which may result in not only inaccurate pipetting but also deterioration of the instrument.
5. Do not hold the instrument horizontally or upside down when there is liquid inside the tip, otherwise the liquid will get inside the main body, which may cause deterioration of the instrument.
6. If liquid is sucked inside the main body (inside the nozzle), clean as quickly as possible. Liquid inside the nozzle is a main cause of precision/reproducibility loss and may lead to breakdown of the instrument.
7. When turning the push button, do not exceed the specified sample volume limit, as this may damage the instrument or cause deterioration.
8. Do not perform pipetting with less liquid than the set volume. If the quantity is less than the set volume, this may cause the liquid to scatter into the main body, which may result in deterioration of the instrument.
9. The pipette can be used between +4°C and +40°C, but the specifications may vary.
10. Depending on the frequency of use, the pipette should be cleaned in a soap solution and maintained the airtight chamber according to this manual.

# Contents

- Operating procedure ..... 5
- Disassembling/Reassembling the airtight chamber ..... 9
- Specifications ..... 10
- Troubleshooting ..... 11
- Parts list ..... 12

## V. Operation



### 1. Volume setting

For each volume, the graduation consists of three numerical values that are read from top to bottom.

Turn the push button to the left or right, aligning it with the numerical value of the setting volume.

\* Graduation units of each model are as shown in the chart below.

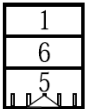
**Fig.A Volume graduation unit chart**

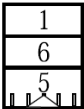
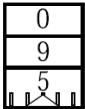
NLE-10	NLE-20	NLE-100	NLE-200	NLE-1000
				
9.5 $\mu$ l	16.5 $\mu$ l	95 $\mu$ l	165 $\mu$ l	950 $\mu$ l (0.95 ml)

### Observe the following cautions when setting volume.

- 1) When setting to an increased volume → First exceed the desired setting graduation by about 1/3 revolution, then adjust the indication to the desired graduation.
- 2) When setting to a decreased volume → Slowly turn to the precise point, being careful not to go past the desired graduation setting.

### **Caution:**

- **Do not exceed the stipulated volume range or change the volume capacity. This could damage the instrument or impair quality.**  
**(Never turn the push button more than 1/3 revolution past the maximum stipulated volume).**

## 2. Aspirating liquid (Forward method)

- 1) Attach a new tip to the nozzle end. (We recommend that you attach it from rack)

**Note: It would be recommended that tips are directly picked up from rack.**  
**And do not twist pipette when fixing tip.**

- 2) Press down push button to first stop position "b". (Fig. A)  
\* Don't aspirate the liquid with the push button pressed at the second stop "c".
- 3) Hold the pipette vertically and immerse the tip 2mm to 3mm below the surface of the liquid. (Fig. B-①)
- 4) Release the push button slowly and smoothly to aspirate the set volume of the liquid. (Fig. B-②)
- 5) Wait 1 to 2 seconds, then withdraw the pipette vertically and carefully from the surface of the liquid. (Fig. B-③)
- 6) Wipe any droplets away from the outside of the tip using a medical wipe and avoid touching the tip's orifice.

**Note: Do not aspirate when push button position is at "c".**

**Note: The push button has to be pushed and released slowly. Otherwise it may cause wrong accuracy.**

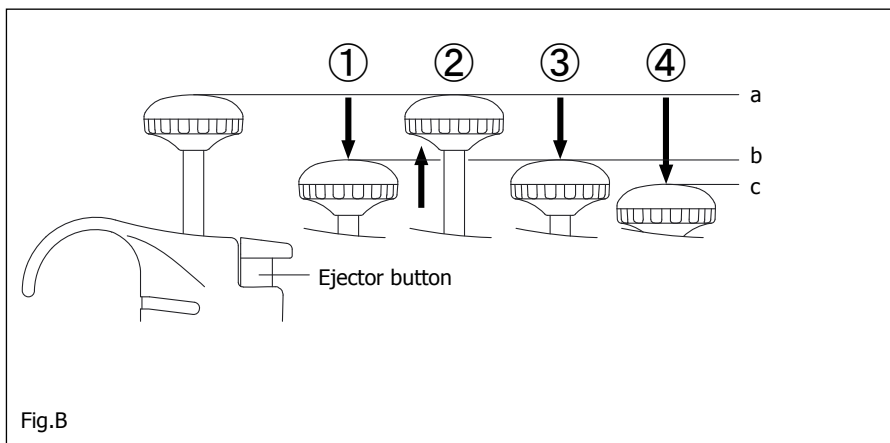

### 3. Dispensing liquid

- 1) Gently place the end of tip against inside wall of recipient vessel just above liquid surface 10 degrees to 45 degrees in angle.
- 2) Press down the push button slowly and smoothly to the first stop "b". Wait for a few seconds then press down the push button to the second stop to expel the last drop of the liquid from the tip. (Fig. D-④,⑤)
- 3) Release the push button slowly.
- 4) Press the ejector button to remove the tip and dispose of it. (Fig. D-⑥)

#### **⚠ Caution:**

**When using any toxic or harmful liquid to human, do not touch any used tips.**

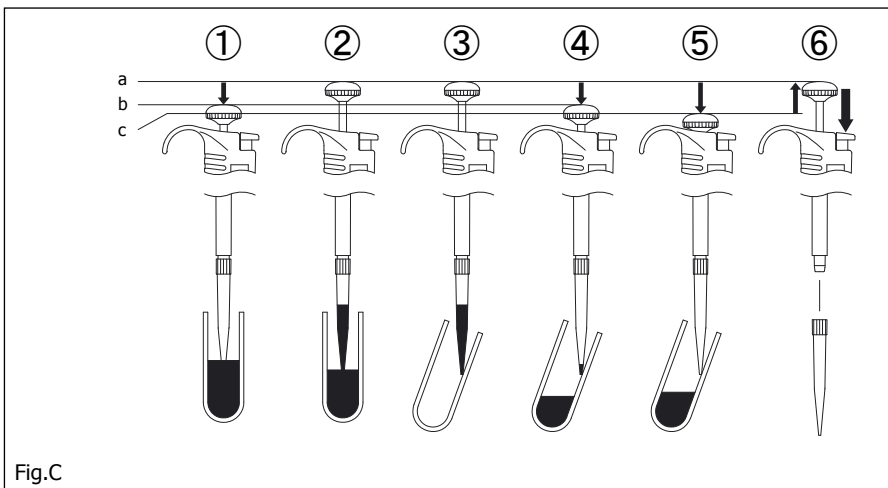

#### **(Reference)**

##### **1) Pre-rinsing**

When attaching a new tip, before sampling, repeat suction and discharge of liquid to the first stop position 2 to 3 times.

Pre-rinsing will result in a high degree of accuracy. In addition, especially when strict accuracy is sought, we recommend this method when sampling various types of liquid.

##### **2) Sampling high density liquids and viscous solutions**

When aspirating, once the liquid has entered the tip, wait 2 to 3 seconds before removing the tip from the liquid. When dispensing, wait 2 to 3 seconds at the first stop position before pushing to the second stop position.



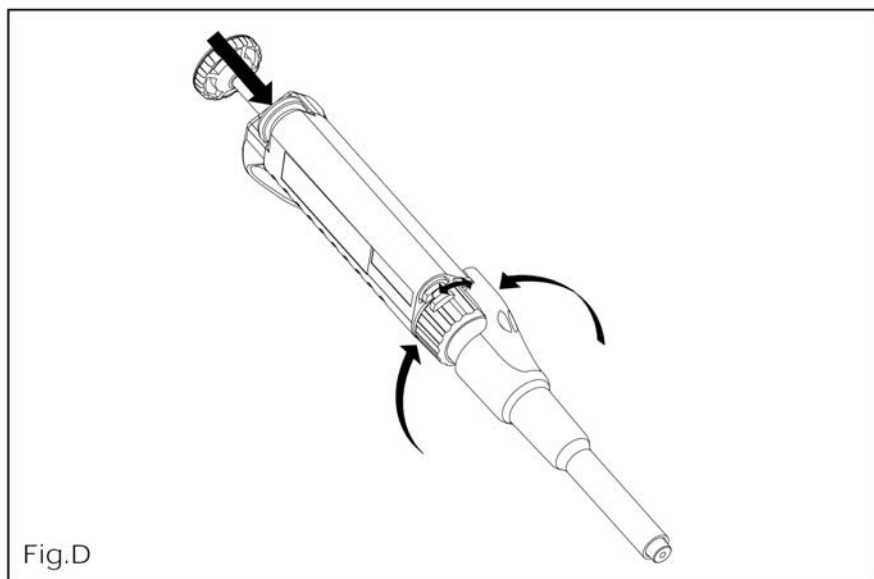

Fig.D

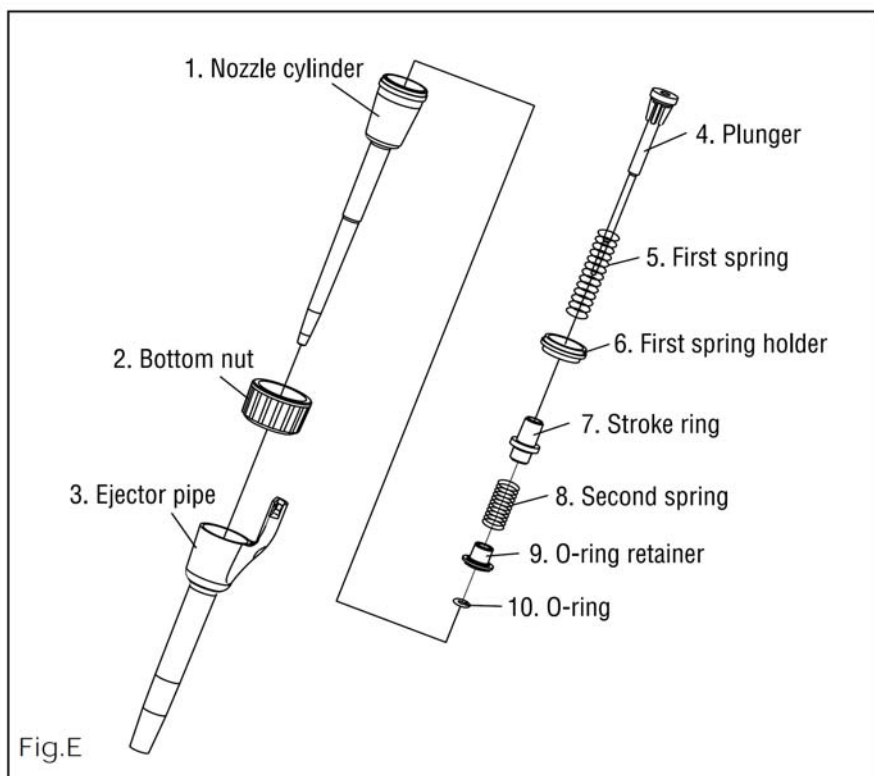

Fig.E

## VI. Disassembly and assembly of airtight section

For airtight section maintenance, or when a problem such as that clearly stated in the "Trouble Shooting" section of this manual occurs, carry out disassembly, inspection and cleaning following the instructions below.

### 1. Disassembly

- 1) Remove the ejector pipe.

With the ejector button depressed, slide the ejector pipe to the right (clockwise direction) and remove from the ejector shaft. Next, pull out the ejector pipe. (Refer to Fig.D).

- 2) Remove the bottom nut.

While holding down the nozzle cylinder, turn the bottom nut counter clockwise and remove from the body.

**At this time the spring inside the nozzle cylinder may cause the internal parts to pop out. Please use care and remove slowly.**

- 3) Remove each part.

Remove the parts in the nozzle cylinder: First spring, plunger, first spring holder, second spring and O-ring. (The plunger and first spring holder are a complete set on the 1000ul model). Once removed, carry out part replacement, inspection and cleaning of the airtight section.

### Caution:

- **During disassembling take care not to lose any of the parts.**

### 2. Assembly

\* Basically assembly is done in the reverse order of disassembly. (Refer to Fig.E ).

- 1) Set the O-ring on the O-ring holder.
- 2) With the plunger tip facing upward, attach each part in the order of first spring → first spring holder → stroke pipe → second spring → O-ring retainer → O-ring. Next, insert in the nozzle cylinder.
- 3) Install the ejector pipe. Install in the reverse order of disassembly.

### Caution:

- **After assembly, before using the unit, test-operate it a few times to confirm that there are no problems**

## VII. Specifications

Nichiryo Le (model No. NLE) is a high quality pipette. The technical figures given in the Table-1 "NLE Maximum Permissible Errors" were obtained using genuine Nichiryo BMT tips. Nichiryo declares that pipettes comply with the requirements of the ISO 8655 Standard, by type testing. The adjustment is carried out under strictly defined and monitored conditions (ISO 8655-6):

- The basis of adjustment, EX
- Reference temperature, 20°C
- Relative humidity, 50%
- Barometric pressure, 101KPa
- Use of distilled water grade 3 (ISO 3696)
- Ten measurements for each test volume at three points, nominal volume, 50% of nominal volume and the minimum or 10% of nominal volume.

**Table-1 NLE Maximum Permissible Errors**

Code	Volume range (uL)	Measured volume(uL)	Accuracy (systematicerror) (%)	Precision (randomerror) (%)
NLE-10	1~10	1	±6.0 *	≤5.0 *
		5	±2.0	≤1.6
		10	±1.2	≤0.8
NLE-20	2~20	2	±5.0 *	≤3.0 *
		10	±2.0	≤1.0
		20	±1.0	≤0.5
NLE-100	10~100	10	±2.0	≤1.0
		50	±1.2	≤0.6
		100	±0.8	≤0.3
NLE-200	20~200	20	±1.2	≤1.0
		100	±1.0	≤0.6
		200	±0.8	≤0.3
NLE-1000	100~1000	100	±1.2	≤0.8
		500	±1.0	≤0.6
		1000	±0.7	≤0.3

\*Accuracy and reproducibility of 1uL on the NLE-10 model and 2uL on the NLE-20 model will be greatly influenced by the operator's sampling skill.

\* The data given in the table conform to the ISO 8655-2 standard.

## VIII. Trouble Shooting

Problem	Probable cause	Solution
Liquid is not suctioned	Inside of nozzle cylinder point is clogged (foreign matter buildup)	Clean or replace the nozzle cylinder part.
	The nozzle cylinder is loose	Retighten the bottom nut.
	The O-ring is worn	Replace the O-ring.
Suctioned liquid leaks from the tip	The O-ring is worn	Replace the O-ring.
	Airtight section lubricant (grease) has been used up.	Grease the airtight section.
	Nozzle cylinder point is worn. (Visual inspection shows level difference).	Replace the nozzle cylinder.
	Plunger surface is scratched or damaged.	Replace the plunger.
	The tip being used does not fit the nozzle.	Change the tip used.
Push button operation is poor	Plunger and O-ring lubricant (grease) has been used up.	Grease the plunger and O-ring.
	Liquid has been drawn into the unit (inside of nozzle cylinder)	Disassemble the lower part and clean.
	Plunger surface is dirty or foreign matter has adhered to it.	Disassemble the lower part and clean or replace the plunger.

- \* If you experience any problems other than those noted above, or if there is still a problem even after carrying out the recommended solutions, please stop using the instrument immediately and request service. At that time please be sure to make sure that the instrument is not contaminated with any substances such as microbes or chemicals that are harmful to the body.

## ■ Replacement parts list (Service parts list)

	Description	NLE-10	NLE-20	NLE-100	NLE-200	NLE-1000
①	Nozzle cylinder	NPE-024A	NPE-024B	NPE-024C	NPE-024D	NPE-024E
②	Bottom nut	NPE-030 *Same for all volume sizes.				
③	Ejector pipe	NPE-025A	NPE-025B	NPE-025B	NPE-025B	NPE-025C
④	Plunger	NPE-017A	NPE-017B	NPE-017C	NPE-017D	NPE-017E
⑤	First spring	NPE-017A	NPE-017B	NPE-017C	NPE-017C	NPE-017D
⑥	First spring holder	NPE-020A	NPE-020A	NPE-020A	NPE-020A	NPE-020B
⑦	Stroke ring	NPE-018A	NPE-018A	NPE-018A	NPE-018A	NPE-018B
⑧	Second spring	NPE-023A	NPE-023A	NPE-023A	NPE-023A	NPE-023B
⑨	O-ring retainer	NPE-021A	NPE-021B	NPE-021C	NPE-021D	NPE-021E
⑩	O-ring	NPE-022A	NPE-022B	NPE-022C	NPE-022D	NPE-022E
⑪	Grease	N3-0711A	N3-0711A	N3-0711A	N3-0711A	N3-0711A

\* As the above replacement parts are specifically designed for each volume size, please indicate the volume size of your instrument when placing your order.

## ■ Nichiryo Genuine Tips

### ● Tips (Autoclavable)

Code	Volume range (uL)	Color	Applicable model	Tip length (approx. size)	Number of tips
BMT2-SS	0.5~10	clear	NLE-10	45.7mm	1000 tips
BMT2-SG	2~200	clear	NLE-20/100/200	53mm	1000 tips
BMT2-LG	100~1000	clear	NLE-1000	81.9mm	1000 tips

### ● Racked tips (Autoclavable)

Code	Volume range(uL)	Color	Applicable model	Number of tips
BMT2-SSR	0.5~10	clear	NLE-10	960 tips (96 tips x 10 cases)
BMT2-SGR	2~200	clear	NLE-20/100/200	960 tips (96 tips x 10 cases)
BMT2-LGR	100~1000	clear	NLE-1000	960 tips (96 tips x 10 cases)

## Memo

## Memo

## Inspection and Calibration Statement

The enclosed pipette was tested and calibrated under closely controlled environmental conditions to ensure that it meets published calibration specifications. The precision and accuracy results obtained for this pipette are provided on the enclosed calibration certificate.

Because temperature and humidity conditions affect the calibration results of liquid measurement devices, your pipette should be calibrated under conditions of use. The calibration results obtained in your laboratory may vary from our results due to differences in environmental testing conditions.

For repair, service or information you may contact your local distributor.



Manufacturer:

 **NICHIRYO CO.,LTD.**

Tokyo office

1-10-1 Kandanishiki-cho, Chiyoda-ku, Tokyo 101-0054, Japan

TEL: +81-3-6273-7652(English) FAX: +81-3-6273-7944

URL: <http://www.nichiryo.co.jp/>

E-mail: [i-sales@nichiryo.co.jp](mailto:i-sales@nichiryo.co.jp)